

# 30" VANITY

## SPECIFICATIONS

- 5 Panel Shaker Door Design
- Comfort Height Of 34"
- Generous Interior Storage
- Adjustable Hinges
- Made In The USA

## CONSTRUCTION AND MATERIALS:

**Core Substrate:** Engineered Wood Panel

**Overlay:** High Resolution Wear Resistant Laminate & Textured PVC Edge Banding

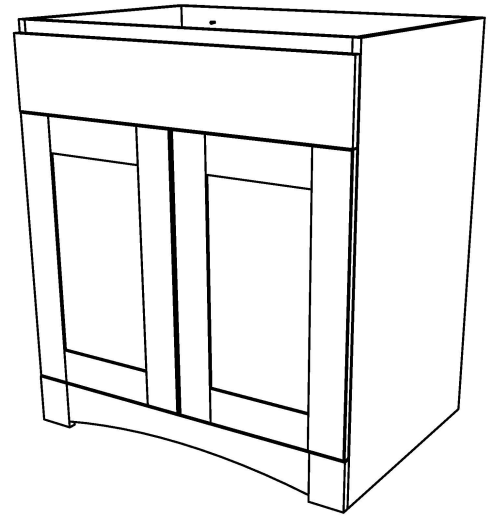

## PRODUCT DIMENSIONS

Width: 30"

Depth: 21<sup>5</sup>/<sub>8</sub>"

Height: 34"

Weight: 53 lbs.

## PACKAGED DIMENSIONS

Width: 32<sup>3</sup>/<sub>4</sub>"

Depth: 23<sup>7</sup>/<sub>8</sub>"

Height: 36"

Weight: 59 lbs.

**FRONT**

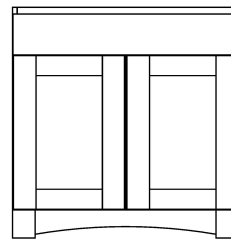

**SIDE**

