

REVISED 2021-05-08

PACKAGE CONTENTS

PART	DESCRIPTION	QUANTITY	Stock Part#
AA	Crossbar Assembly	1 pc	N/A
BB	Wire Connector	3 pcs	
CC	Outlet Box Screw	2 pcs	
DD	Quick Link	2 pcs	
A	Ceiling Canopy	1 pc	
EE	Fixture Chain	1 pc	M382CHMBK
B	Fixture Body	1 pc	N/A
C	Shade	4 pcs	G13524SH

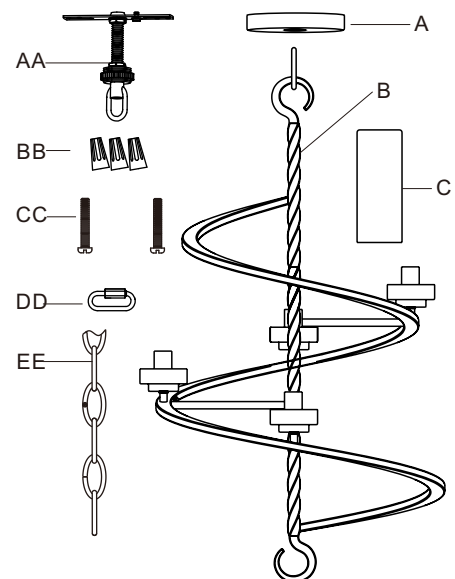

Questions, problems, missing parts?

Before returning to your retailer, call our customer service at 1-800-645-3184, Monday - Friday, 7:00 a.m. - 4:00 p.m., CST.

HARDWARE CONTENTS Note: Hardware is not shown to actual size.



AA Crossbar Assembly
x 1



BB Wire Connector
x 3



CC Outlet Box Screw
x 2



DD Quick Link
x 2



EE Fixture Chain
x 1



SAFETY INFORMATION

Please read and understand this entire manual before attempting to assemble, operate or install the product.

WARNING:

- Turn off electricity at main fuse box (or circuit breaker box) before beginning installation by removing fuse (or switching off circuit breaker).
- Be careful not to damage or cut the wire insulation (covering) during fixture installation. Do not permit wires to contact any surface having a sharp edge. To do so may damage or cut the wire insulation, which could cause serious injury or death from electric shock

CAUTION:

- All electrical connections must be in agreement with local codes, ordinances or the national electric code (NEC). Contact your municipal building department to learn about your local codes, permits and/or inspections.
- Risk of fire – most dwellings built before 1985 have supply wire rated for 140°F/60°C. Consult a qualified electrician before installation.
- Do not connect this fixture to an electrical system that does not provide a means for equipment grounding. Never use a fixture in a two-wire system that is not grounded. If you are not sure your lighting system has a grounding means, do not attempt to install this fixture. Contact a qualified, licensed electrician for information with regards to proper grounding methods as required by the local electrical code in your area.
- If a dimmer control switch is used with this fixture, obtain professional advice to determine the correct type and electrical rating required.

PREPARATION

Before beginning assembly, installation or operation of product, make sure all parts are present. Compare parts with package contents list and diagram on previous page. If any part is missing or damaged, do not attempt to assemble, install or operate the product. Contact customer service for replacement parts

Bulb Recommended: (4) 60W B10 Candelabra Bases (Not Supplied), Alternate (4) LED bulb.

Tools required for assembly (not included): Flathead screwdriver, Phillips screwdriver, Pliers, Electrical tape, Wire cutter, Safety glasses, Ladder.

ASSEMBLY INSTRUCTIONS

STEP 1:

- Secure the crossbar assembly (AA) to the outlet box (not included) with the outlet box screws (CC).
- Tighten until snug.

STEP 1

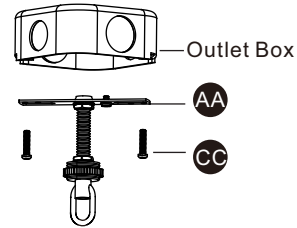

STEP 2:

- Remove the pre-assembled canopy lock ring from the crossbar assembly (AA).
- Temporarily attach the ceiling canopy (A) to the pre-assembled nipple on the crossbar assembly (AA).
- Secure with the canopy lock ring.

Note:

If the ceiling canopy (A) is not snug against the ceiling, remove it from the crossbar assembly (AA) and adjust the length of the pre-assembled nipple by unscrewing the pre-assembled hex nut. Screw the nipple in or out of the crossbar until the correct length is achieved. Then, re-attach the ceiling canopy (A).

STEP 2

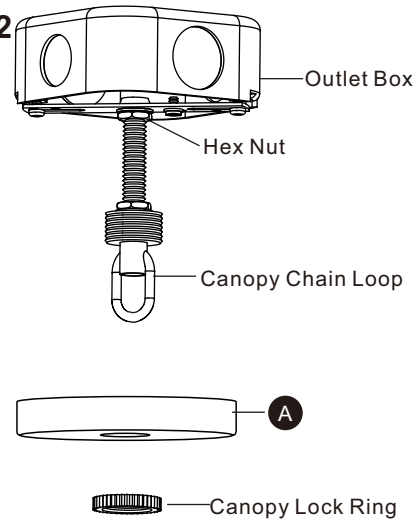

STEP 3:

- Choose desired hanging length for the light fixture. Suggested mounting height over a table or island is 30 inches from the table/island top to the bottom of the fixture.
- Adjust the fixture chain (EE) to the desired length, removing links if needed.
- Connect one end of the fixture chain (EE) to the canopy chain loop preassembled to the crossbar assembly (AA) with one quick link (DD).
- Connect the other end of the fixture chain (EE) to the fixture loop with the remaining quick link (DD).

Note: You may need to use pliers (not included) to open the links of the fixture chain (EE). If so, put a cloth over the fixture chain (EE) to protect the finish from the pliers.

Suggested chain length to hang fixture 30 inches above table top:

8' ceiling: 4 inch chain + (2) quick links

9' ceiling: 16 inch chain + (2) quick links

10' ceiling: 28 inch chain + (2) quick links

11' ceiling: 40 inch chain + (2) quick links

STEP 3

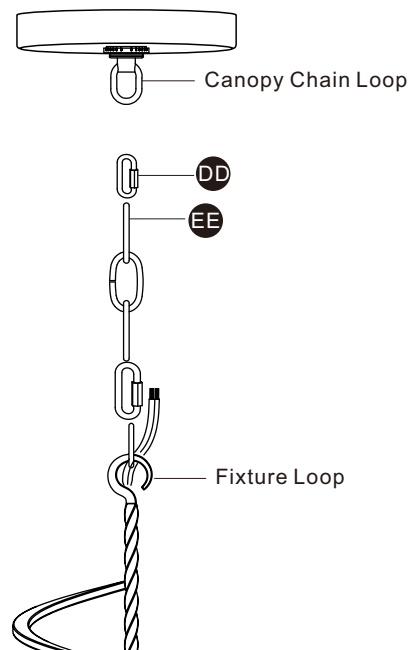

ASSEMBLY INSTRUCTIONS

STEP 4:

- Confirm that the mounting height is acceptable. Refer to STEP 3 if changes are required.
Note: To make the next step easier, cut the supply wire and ground wire 24 inches longer than the distance from the fixture loop to the ceiling. Important: please pay attention to the polarity (wires labeled L & N) when cutting wires. Wire identification will be needed in STEP 6.
- Pull the supply wires and ground wire up through the fixture chain alternating links.
- Push the ends of the supply wires and ground wire up through the canopy chain loop and into the outlet box. The remaining slack wire will be inserted into the outlet box in STEP 5.

STEP 4

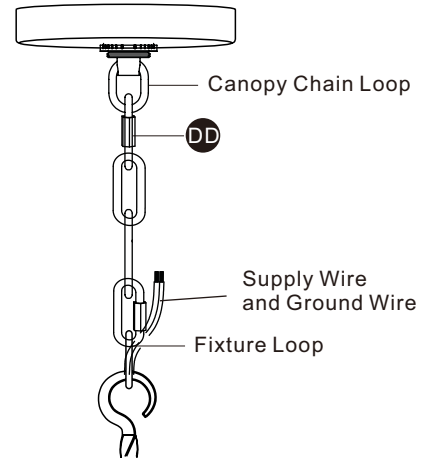

STEP 5:

- Unthread the canopy lock ring.
- Slide the canopy lock ring and the ceiling canopy (A) down the quick link (DD).
- Push all slack fixture wire through the canopy chain loop and into the outlet box.
- Trim excess fixture wire leaving a minimum of 6 inches hanging out of the outlet box.
- Separate the smooth side and ribbed side of the supply wire to about 3 inches from the end.
- Using wire strippers, strip each wire ½ inch from the end.

STEP 5

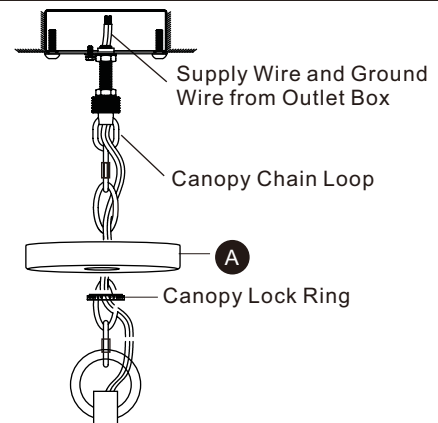

STEP 6:

***Use the wire connectors (BB) to connect the wires.**

- Connect the **house ground wire** to the **fixture ground wire**.
- Connect the **house white wire** to the **fixture supply wire (ribbed sided)** from fixture identified with the label "N".
- Connect the **house black (or red) wire** to the **fixture supply wire (smooth side)** from fixture identified with the label "L".
- Wrap each connection with approved electrical tape and carefully insert all of the connected wires into the outlet box.

STEP 6

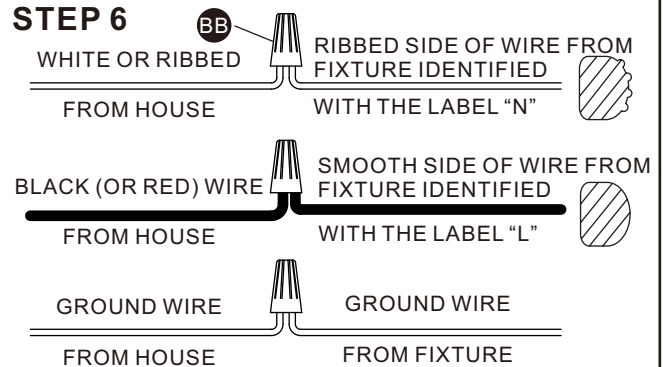

ASSEMBLY INSTRUCTIONS

STEP 7:

- a. Attach the ceiling canopy (A) back over the canopy chain loop.
- b. Secure with the canopy lock ring.

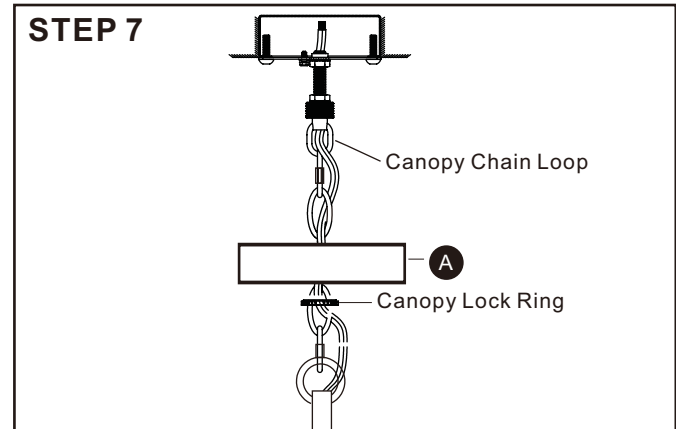

STEP 8:

- a. Install the correct bulbs (not included) referring to fixture markings and/or labels for maximum wattage.

STEP 9:

- a. Place the shade (C) over the cap on the fixture body (B).

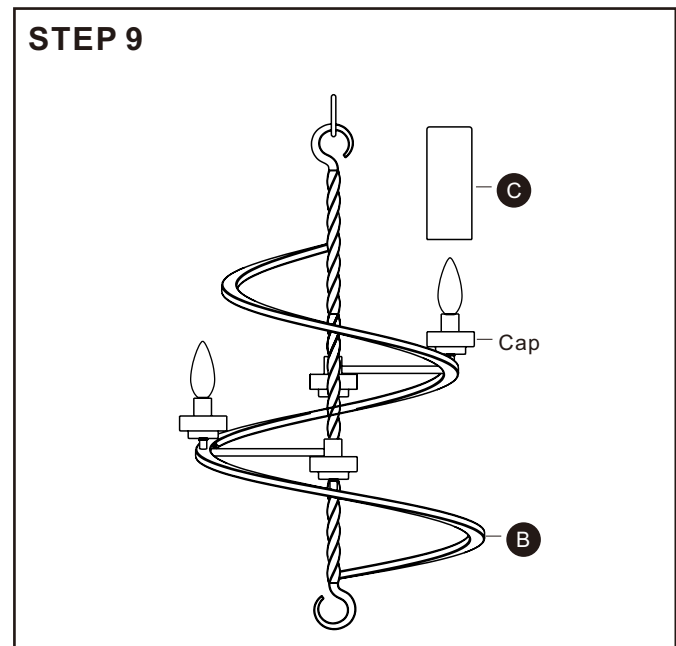

Your installation is completed now. Restore electricity. Retain this sheet for future reference.

CARE AND MAINTENANCE

- To clean, turn off and wipe with a damp, non-abrasive cloth.

TROUBLESHOOTING

1) The lights will not turn on:

- a) Make sure the wall switch and circuit breaker are on.
- b) Make sure the wiring is correct.

2) Fuse blows or circuit trips when light is turned on.

- a) Check for crossed wires, ensure wiring is correct.

If unable to fix any of the above issues, please consult a certified electrician.

FIVE-YEAR LIMITED WARRANTY: If, during normal use, this PATRIOT LIGHTING® light breaks or fails due to a defect in material or workmanship within five (5) years from the date of original purchase, simply bring this light with the original sales receipt back to your nearest MENARDS® retail store. At its discretion, PATRIOT LIGHTING® agrees to have the light or any defective part(s) repaired or replaced with the same or similar PATRIOT LIGHTING® product or part, free of charge, within the stated warranty period, when returned by the original purchaser with the original sales receipt. This warranty; (1) excludes expendable parts; (2) shall be void if this tool is used for commercial and/or retail purposes; and (3) does not cover any losses, injuries to persons/property or costs. This warranty does give you specific legal rights and you may have other rights, which vary from state to state.



Questions, problems, missing parts?

Before returning to your retailer, call our customer service at 1-800-645-3184, Monday - Friday, 7:00 a.m. -4:00 p.m., CST .